



Maintenance-Free Rechargeable Sealed Lead-Acid Battery



MSB-300 (2V, 300AH)

FEATURES

- Sealed construction, no electrolyte leakage or spill
- Maintenance free operation, no need to fill in water
- Expected life span of 15 years in float service at 20 degree C
- High performance alloy to secure corrosion-proof feature
- Unique electrolyte system achieves maximum service life
- Low self-discharge rate, lower than 3% capacity loss per month
- Special paste formula promotes the good charging acceptance

PERFORMANCE SPECIFICATIONS

Nominal Voltage(V).....	2 V
Nominal Capacity(AH)	
10 hour rate F.V.(1.80V/cell)	300A.H.
5 hour rate F.V.(1.75V/cell)	240A.H.
1 hour rate F.V.(1.60V/cell)	195A.H.
Approximate Weight.....	21kg(46.31lbs.)
Terminal	
Standard.....	Type B6
Internal Resistance (Fully Charged Battery).....	<1mΩ
Maximum Discharge Current For 5 sec.(A).....	1350A
Maximum Charge Current(A)	60A
Ambient Temperature	
Charge.....	0°C(32°F)~40°C(104°F)
Discharge.....	-20°C(-4°F)~50°C(122°F)
Storage.....	-20°C(-4°F)~40°C(104°F)
Vibration test:	
Frequency: 16.7 HZ	
Amplitude: 4mm	
Vibrate the battery horizontally or vertically for 60 minutes.The battery have no abnormality.	
Case.....	ABS
Dimension(mm/inch)	
Length ± 2mm.....	171/6.73
Width ± 2mm.....	151/5.94
Container Height ± 2mm.....	330/12.99
Total Height ± 2mm.....	366/14.41
Application.....	Telecom, UPS, Energy Storage Systems, Central Office.

MSB-300 Battery Discharge Characteristics (25°C/77°F)

Note : C=10HR Nominal Capacity(Ah)

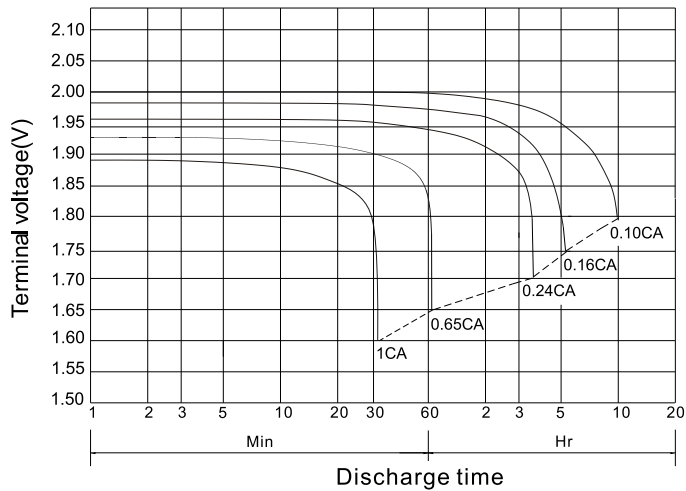

Battery Charging Characteristics

(Typical example of the charge characteristic for the standby use)

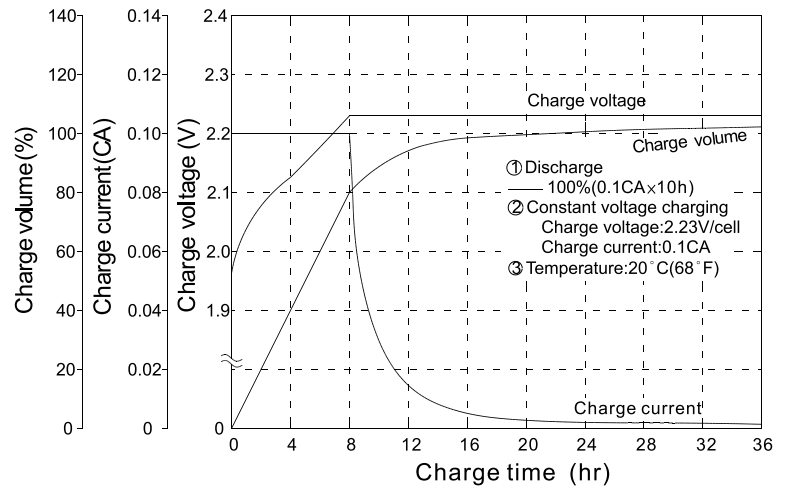

Charging Procedure

Application	Charging method	Charging Voltage at 20°C (V/cell)	Temperature compensation coefficient (mV/°C/cell)	Max. charging current (A)	Charging time 0.1CA, 20°C (h)	
					100% discharge	50% discharge
For standby power source	Constant voltage (with current restriction)	2.23~2.25	-3	60	24	20

*Temperature compensation of charging voltage is not needed, when the batteries are used within 5°C to 35°C range.

Effect of Temperature on Long Term Float Life

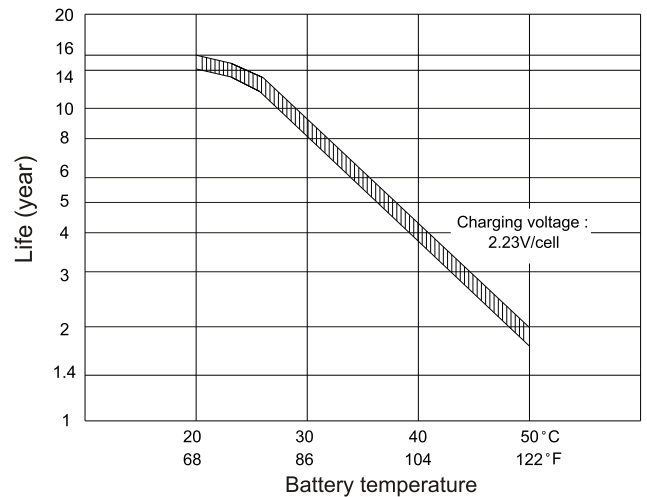

Outer Dimensions mm(inch)

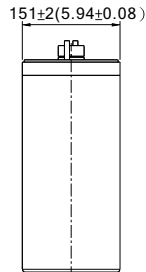
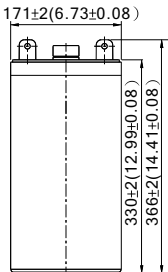
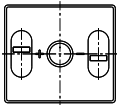

Terminal Type mm(inch)

● Terminal B6

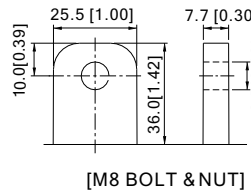

Constant Power Discharge Characteristics At 25°C/77°F

Final Voltage	Discharge time										
	30Min	1Hr	2Hr	3Hr	4Hr	5Hr	6Hr	8Hr	10Hr	12Hr	20Hr
1.80V	436	297	163	141.8	113.6	97.7	85.0	71.4	60.3	47.6	29.8
1.70V	525	337	183	154.0	123.2	106.1	91.7	75.1	64.1	48.1	30.1
1.60V	568	349	190	159.1	127.7	109.1	94.3	77.0	65.3	49.0	30.6



B.B. BATTERY CO., LTD.

Web Site: <http://www.bb-battery.com>

USA:
B&B BATTERY(USA) INC.
6415 RANDOLPH ST.COMMERCE,
CA,90040 U.S.A.
TEL:1-323-278-1900.1-800-278-8599
FAX:1-323-278-1268
E-Mail:sales@bb-battery.com

EUROPE:
B&B BATTERY(EUROPE) B.V.
3 WIJNGAARDVELD, 9300 AALST,BELGIUM
TEL:(00)32-53781567
FAX:(00)32-53781567
E-Mail:hansdevriese@bb-battery.com

CHINA FACTORY:
B.B. BATTERY CO., LTD.
CHENG DONG TRIAL AREA,HUANG GANG,
RAOPING, GUANG DONG,CHINA,515700
TEL:86-768-7601001-2
FAX:86-768-7601469
E-Mail:maggy@bb-battery.com

HONG KONG:
NATIONAL TRADING LTD.
TEL:852-2301-3800
FAX:852-2739-1182
E-Mail:bbhk@hkstar.com

JAPAN:
B&B BATTERY(JAPAN) CO., LTD.
1375-11 NARAHARA-MACHI,HACHIOJI,
TOKYO 193-0803,JAPAN.
TEL:81-426-256-537
FAX:81-426-256-537
E-Mail:miyata@bb-battery.com

TAIWAN:
B.B. BATTERY(TAIWAN) CO., LTD.
TEL:886-6-502-5150
FAX:886-6-589-8087
E-Mail:maggy@bb-battery.com

